

## Accessories

<b>PONSSE special tools .....</b>	<b>135</b>
special tools.....	135
Special tools .....	136
Motor service tools.....	136
Wire connection tools .....	136
Torque wrenches .....	137
Spanner wrenches.....	137
Extractors .....	137
Hydraulic cylinder wrenches .....	138
T-Wrenches .....	138
Electric hand tools .....	138
Pneumatic hand tools.....	138
Hydraulic tools .....	139
Welding equipment .....	139
Battery maintenance .....	139
Repair shop machinery and equipment.....	139
Lifting equipment .....	139
General hand tools .....	140
Chain and track tensioners.....	140
Bars and installation rods .....	140
Ladders, working platforms .....	141
Trestles.....	141
Tool sets .....	141
Dual, Grapple changing tool.....	142
<b>Miscellaneous.....</b>	<b>142</b>
First aid kit .....	142
Powder fire extinguisher and accessories .....	142
Logger's tape measure .....	142
Plastic container.....	142
Main current switch wrench .....	143
Tyre inflator .....	143
Tool box.....	143
Equipment box.....	143
Hinges .....	143
Fuel filling pumps .....	144
Hydraulic oil filling pumps .....	144
Filling hoses .....	144
Tank caps .....	144
Oil absorbent paper.....	144
Sight glasses .....	144
Manual lubrication .....	145
Centralised lubrication .....	145
Spare belts .....	145
Pressure gauges .....	145
Pressure gauge hoses.....	145

**PONSSE special tools**



SPECIAL TOOLS																									
		BEAR	ERGO	BEAVER	HS16	HS15	COBRA	HS10	ELEPHANT	BUFFALO	WISENT	BISON	ELK	GAZELLE	CARIBOU	S15	S10	MB	K75	HN125	HN200	C55	H53	H60	H73
Description	No.																								
Middle pivot bearing fastening bolt key wrench	ST0077	X						X	X		X	X													
Middle pivot bearing fastening bolt key wrench	ST0078	X						X	X		X	X													
Middle pivot chucking key	ST0286						X	X						X		X									
Middle pivot vertical pin key	ST0192						X		X		X	X													
Middle pivot horizontal nut tool	ST0062						X	X									X								
Middle pivot tightening tool	ST0004		X		X	X	X	X								X	X								
Middle pivot tightening tool arm	ST00401		X		X	X	X	X								X	X								
Middle pivot ring nut tightener	P16552																								
Cabin tilting key	ST0287	X	X	X	X	X	X	X	X	X	X	X	X	X	X	X	X								
Cabin locking key	ST0300	X	X	X				X		X	X	X	X												
Cabin tilting key S10	ST0346							X																	
Cabin pin removal tool	P24559																								
Installation tool for the hydraulic oil tank's suction hose connector, key size 102 mm	ST0067		X	X	X	X	X	X		X	X	X	X	X	X	X	X								
Installation tool for the hydraulic oil tank's suction hose connector, 120 mm	ST0297		X							X															
Installation tool for the hydraulic oil tank's suction hose connector, 71 mm	ST0298		X	X	X	X	X	X		X	X	X	X	X	X	X	X								
Large pump bolt key wrench (30 mm ring)	ST0050		X		X		X																		
Saw motor dismounting key	ST0040																						X	X	X
Lower pin key	ST0039A																				X	X			
Upper pin key A	ST0198A																				X	X			
Engine turning tool	ST0028																	X							

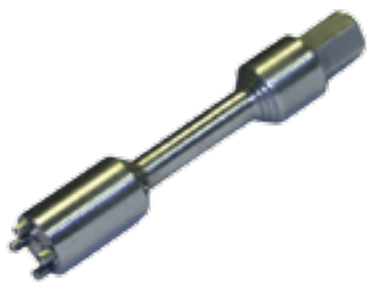

### SPECIAL TOOLS

Description	No.
Special key wrench for tight spaces	ST0052
Have check valve key	ST0022
Harting crimping tool	ST0312
Dismounting tool	ST031201
Spare socket for the dismounting tool	ST031202
Crimp crimping tool, production model	ST0303
Crimp crimping tool, service model	ST0302
Pin extractor	ST0006
Pressure gauge 0–6 bar	ST010901
Pressure gauge 0–60 bar	ST010902
Pressure gauge 0–250 bar	ST010903
Pressure gauge 0–400 bar	ST010904
Pressure gauge 0–600 bar	ST010905
Connecting tube 60 cm	ST010906
Connecting tube 120 cm	ST010907



### MOTOR SERVICE TOOLS

Description	No.
Piston ring expander 80–120 mm	ST0010
Valve spring lifter	ST0013

Description	No.
Piston ring compressor 57–125 mm	ST0015
Stud extractor 6–12 mm	ST0033
Optical antifreeze agent/battery acid meter	ST0025
Oil filter key	ST0105
Alternator belt pulley key	ST0045
XZN key M10 L-MODEL	ST004501
Graduated plate	ST0281
Bearing and seal installation wrench set	ST0234



### WIRE CONNECTION TOOLS

Description	No.
Soldering iron 24V/50W	ST0284
Soldering iron 230V/40W	ST0285
Crimping tool 0.5–2.5 mm <sup>2</sup>	ST0112
Cable shoe crimping tool 0.5–4.0 mm <sup>2</sup>	ST0111
Peeling tool 0.02–10 mm <sup>2</sup>	ST0110
Connection pliers for insulated connectors 1.5–6 mm <sup>2</sup>	ST0113
Connection pliers for uninsulated connectors 1.5–6 mm <sup>2</sup>	ST0114
Connection pliers for uninsulated connectors 0.5–1.5 mm <sup>2</sup>	ST0115
Connection tool for round connectors 1.2 mm	ST011602
Connection tool for round connectors 1.6 mm	ST011601
Connection tool for round connectors 2.5 mm	ST011605
Connection tool for round connectors 3.5 mm	ST011604
Connection tool for round connectors 4.0 mm	ST011603
Connection tool for flat connectors 0558-99984 WURTH	ST011701
Connection tool for flat connectors 0558-99985 WURTH	ST011702



Description	No.
Connection tool for flat connectors 0558-99986 WURTH	ST011703
Connection tool for Micro Timer II and III connectors 1.6 mm	ST011801



## TORQUE WRENCHES

Description	No.
Torque wrench 20–100 Nm with interchangeable heads	ST001901
Torque wrench 25–130 Nm with interchangeable heads	ST001902
Torque wrench 40–200 Nm with interchangeable heads	ST001903
Torque wrench 80–400 Nm with interchangeable heads	ST001904
Torque wrench 160–800 Nm with a 3/4" driver	ST0280
Ratchet insert tool 1/2 9x12	ST001905
Ratchet insert tool 1/2 14x18	ST001906
Ratchet insert tool 3/4 14x18	ST001907
Torque converter key wrench ("multiplier") with a 3/4" driver	ST0020



## SPANNER WRENCHES

Description	No.
Spanner wrench KM 5, socket 1/2"	ST0126
Spanner wrench KM 6, socket 1/2"	ST0127
Spanner wrench KM 7, socket 1/2"	ST0128
Spanner wrench KM 8, socket 1/2"	ST0129
Spanner wrench KM 9, socket 3/4"	ST0130

Description	No.
Spanner wrench KM 10, socket 3/4"	ST0134
Spanner wrench KM 11, socket 3/4"	ST0135
Spanner wrench KM 13, socket 3/4"	ST0231
Spanner wrench KM 14, socket 1"	ST0325
Spanner wrench KM 15, socket 1"	ST0232
Spanner wrench KM 16, socket 1"	ST0324
Spanner wrench KM 17, socket 1"	ST0299
Spanner wrench KM 19, socket 1"	ST0323
Spanner wrench KM 21 for upper pin, socket 1"	ST0198B
Spanner wrench KM 23	ST0039B
Spanner wrench GU 11 long	ST0132
Spanner wrench GU 13	ST0133
Spanner wrench GU 15	ST0236
Spanner wrench KM15	ST0332
Turn exchanger socket	ST0349
GU 11 short	ST0131



## EXTRACTORS

Description	No.
Extractor 1 25–80 mm, bipod	ST001401
Extractor 2 25–130 mm, bipod	ST001402
Extractor 3 50–160 mm, bipod	ST001403
Extractor 4 60–200 mm, bipod	ST001404
Extractor 5 80–250 mm, bipod	ST001405
Extractor 6 80–350 mm, bipod	ST001406
Internal bearing extractor set 12–46 mm	ST0250



### HYDRAULIC CYLINDER WRENCHES

Description	No.
Hydraulic cylinder wrench 220 mm	ST0344
Hydraulic cylinder wrench 450 mm	ST0271
Hydraulic cylinder wrench 500 mm	ST0012
Hydraulic cylinder wrench 500 mm	ST0329A
Hydraulic cylinder wrench 800 mm	ST0329B
Hydraulic cylinder wrench 1,000 mm	ST0329C
Pin set 6/8 550 mm	ST032901
Pin set 10/L 550 mm	ST032902
Pin set 12/14 800 and 1,000 mm	ST032903
Pin set 16 800 and 1,000 mm	ST032904



### T-WRENCHES

Description	No.
T-wrench	ST0288
T-wrench, long	ST028801



### ELECTRIC HAND TOOLS

Description	No.
Battery-operated percussion nut driver M 18 Li-Ion	ST0162
Hot air blower	ST0270
Cordless drill 14.4 V	ST0273
Drill with a shovel handle	ST0275
Percussion drill	ST0274
Gas soldering iron	ST0283
Work lamp 230V / 11W / 5 m, tubular	ST0243
Work light 2x18W/5 m, rectangular	ST0254
Battery tester 6/12 V	ST0172



### PNEUMATIC HAND TOOLS

Description	No.
Pneumatic drill	ST0276
Pneumatic corner drill	ST0277
Needle scaler P2516A	ST0327
Pneumatic gun	0038026

## HYDRAULIC TOOLS

Description	No.
Thrust cylinder CLF220-50 NIKE	ST0139
Thrust cylinder CHFA184A NIKE	ST0141



## WELDING EQUIPMENT

Description	No.
Welding inverter Caddy Arc 151 i A31	ST0163
MIG/MAG welding machine Esab 340A 4 wd	ST0171
Carbon arc gouging pin OK Carbon	ST0328
Combi X 11 security pack, gas welding/cutting equipment	ST0157



## BATTERY MAINTENANCE

Description	No.
Battery charger 220A with a start-up function	ST0165
Battery charger 500E with a start-up function	ST0166



## REPAIR SHOP MACHINERY AND EQUIPMENT

Description	No.
Compressor 2.2 kW with a 20 l tank	ST0175
Hose reel for compressed air, metal 10 mm/10 m	ST0176
Transmission oil pump, pneumatic	ST0304
Tyre pump with gauge	ST0242
Aggregate 6 kW, 230 V	ST0156
Manual pump	ST0138
Compressed air hydraulic pump	ST0140



## LIFTING EQUIPMENT

Description	No.
Lifting tackle 0.75 t	ST0158
Lifting tackle 1.5 t	ST0159
Lifting tackle 3 t	ST0160
Lifting tackle 6 t	ST0161
Hoist 1.3 t, min. 80 mm, max. 740 mm	ST0123
Hoist 2 t, min. 80 mm, max. 795 mm	ST0124
Pneumatic hydraulic crane 25/50t, min. 220 mm, max. 445 mm	ST0345
Bottle jack 10 t, min. 131 mm, max. 223 mm	ST0289
Bottle jack 20 t, min. 234 mm, max. 459 mm	ST0290



### GENERAL HAND TOOLS

Description	No.
Multimeter	ST0122
Multimeter	0056878
TORX wrench SIZE 40, 1/4" driver	ST0235
Bits ratchet set (TORX, hex, 1/4" sockets, ph, pz)	ST0279
Long hose connector socket wrench 41 mm, 3/4" driver	ST0308
Slide gauge 150 mm	ST0251
Micrometer 0–25 mm	ST0253
Micrometer 25–50 mm	ST0252
Dismounting wrench for greaser pump unit, double-headed socket	ST0348
65 mm socket with a 1" driver	ST0018
Double suction cup	ST0282
Service shop hand tool table with tools and equipment	ST0239
Installation worker's tool cabinet without tools	ST0142
Glued plexiglass cutter	ST0125
Glued plexiglass extractor blade 85 mm	ST012501
Hose clamp pliers 291-0067	ST0347
Opti 5 dismounting wrench	ST0333
LED headlamp, special coating	ST0153



### CHAIN AND TRACK TENSIONERS

Description	No.
Chain tensioner for Wallingfords chains G202	ST0294
Chain tensioner for Wallingfords chains G200	ST0295
Tyre chain connector dismounting tool	ST0330
Track tensioner Eco-Track, Eco-Soft, Eco-Of, Eco-Max, Eco-Baltic, Pro-Track, Combination track	ST0292



### BARS AND INSTALLATION RODS

Description	No.
Aluminium bar 1.5 m, 2.8 kg	ST0337
Aluminium bar 1.5 m, 3.6 kg	ST0338
Aluminium installation rod 0.68 m, 0.7 kg	ST0339
Aluminium installation rod 0.68 m, 0.7 kg	ST0340
Aluminium installation rod 0.48 m, 0.5 kg	ST0341
Aluminium installation rod 0.43 m, 0.4 kg	ST0342
Aluminium installation rod 0.82 m, 1.7 kg	ST0343



## LADDERS, WORKING PLATFORMS

Description	No.
Step ladder, step width 45 cm, height 0.47 m	ST018201
Step ladder, step width 45 cm, height 0.70 m	ST018202
Step ladder, step width 45 cm, height 0.93 m	ST018203
Step ladder, step width 45 cm, height 1.15 m	ST018204
Step ladder, step width 45 cm, height 1.38 m	ST018205
KTA-300 (Protec) folding installation platform	ST0191
One-sided industrial steps, step height 0.78 m	ST030901
One-sided industrial steps, step height 1.01 m	ST030902
One-sided industrial steps, step height 1.30 m	ST030903
One-sided industrial steps, step height 1.56 m	ST030904
One-sided industrial steps, step height 2.08 m	ST030905
One-sided industrial steps, step height 2.59 m	ST030906
Folding work ladder, step height 1.75 m	ST031001
Folding work ladder, step height 1.95 m	ST031002
Folding work ladder, step height 2.40 m	ST031003
Standard folding scaffold, expandable platform 0.75 x 1.8 m	ST031101
Standard folding scaffold, expandable platform 1.35 x 1.8 m	ST031102
Secure step platform TRT-106	ST018801
Secure step platform TRT-108	ST018802
Secure step platform TRT-109	ST018803
Secure step platform TRT-110	ST018804
Secure step platform TRT-112	ST018805
Secure step platform TRT-115	ST018806



## TRESTLES

Description	No.
Axle trestle SFTA512	ST0313
Axle trestle SFTBE522	ST0314
Axle trestle SFTBE523	ST0315
Trestle 15 t	ST0316
Trestle 15 t	ST0317
Trestle 20 t	ST0318
Trestle 20 t	ST0319



## TOOL SETS

Description	No.
Basic tool set	ST0336
Expanded tool set for forwarders	ST0334
Expanded tool set for harvesters	ST0335



### DUAL, GRAPPLE CHANGING TOOL

Description	No.
DUAL, Grapple changing tool	P14365
DUAL, Grapple changing tool	P16798

## Miscellaneous



### FIRST AID KIT

No.
0035540



### POWDER FIRE EXTINGUISHER AND ACCESSORIES

Description	No.
Powder fire extinguisher	0061814
Fire extinguisher bracket	0058112
Fire extinguisher fluid	0062268



### LOGGER'S TAPE MEASURE

Description	No.
Logger's tape measure	0062659
Tape measure with fastener	161620
Fastener for tape measure	25M4010



### PLASTIC CONTAINER

Description	No.
1 L	0021719
10 L	0021718



## MAIN CURRENT SWITCH WRENCH

Description	No.
Main current switch wrench	BOS1342026002



## TYRE INFLATOR

Description	No.
Tyre inflator	0030957



## TOOL BOX

Size	No.
430x205x200	0035544
350x200x170	0058227



## EQUIPMENT BOX

Description	No.
Equipment box Beaver	P17159
Gas Spring for Equipment box	0055191



## HINGES

Description	No.
Weld-on hinge, small	0026576
Weld-on hinge, large	0026579
Screw-on hinge, small (60X30)	0026559
Screw-on hinge, medium (60X40)	0026574
Screw-on hinge, large (60X80)	0026575



### FUEL FILLING PUMPS

Description	No.
JABSCO	0048337
HYDAC	0058492



### HYDRAULIC OIL FILLING PUMPS

Description	No.
FLUTEC	0058493



### FILLING HOSES

Description	No.
For hydraulic oil	AM00069
For fuel	AM00070



### TANK CAPS

Description	No.
W/O lock	0060075
Whit lock	0055101
Seal	00551011
Spare key	00551012

### OIL ABSORBENT PAPER

Description	No.
Oil absorbent paper	0058668
Oil absorbent paper TECTMAT 8279	0068072



### SIGHT GLASSES

Description	No.
Long, M12	0042100
Short, M12	0042101
Short, MB-models	0060132



## MANUAL LUBRICATION

Description	No.
Grease gun, LINCOLN	0028555
Grease gun hose	0029017
Grease gun head, LINCOLN	0029025



## CENTRALISED LUBRICATION

Description	No.
Filling device, SAFEMATIC	0035460
Filling device, SAFEMATIC NLGI2	0060656
Nipple set + Crimping tool	SM11800064
Vaseline EP 00, 18 kg	0033804
Vaseline EP 1, 18 kg	0061307
Vaseline EP 2, 18 kg, Operating temperature -30...+110°C.	005678420



## SPARE BELTS

Description	No.
0.3 m	0028887
0.5 m	0028888
0.8 m	0028889



## PRESSURE GAUGES

Description	No.
0-6 BAR	ST010901
0-60 BAR	ST010902
0-250 BAR	ST010903
0-400 BAR	ST010904
0-600 BAR	ST010905
Rubber protective cover	0035501

## PRESSURE GAUGE HOSES

Description	No.
Pressure gauge hose, long	ST010906
Pressure gauge hose, short	ST010907



# AGILITY AND POWER IN THINNING

## PONSSE FOX



The **new PONSSE Fox** is a true all-terrain harvester. The Fox features eight wheels and a powerful crane located close to the cabin, meaning it performs in the most demanding harvesting situations. Be it on difficult terrain or in soft conditions, you can work comfortably and efficiently. With the new Fox, Ponsse delivers just what customers were ordering: the best weight distribution, stability and visibility we have ever produced.

The **PONSSE C22 crane** puts the Fox in a class of its own. The C22 features multiple reaches (11 metres using the H53e harvester head, and 10,3 metres with the H6 harvester head) and is quick, easy and accurate to control. Drivers and nature alike will thank the new terrain-saving Fox.

A logger's best friend

[www.ponsse.com](http://www.ponsse.com)